

AGS 400 EN_L

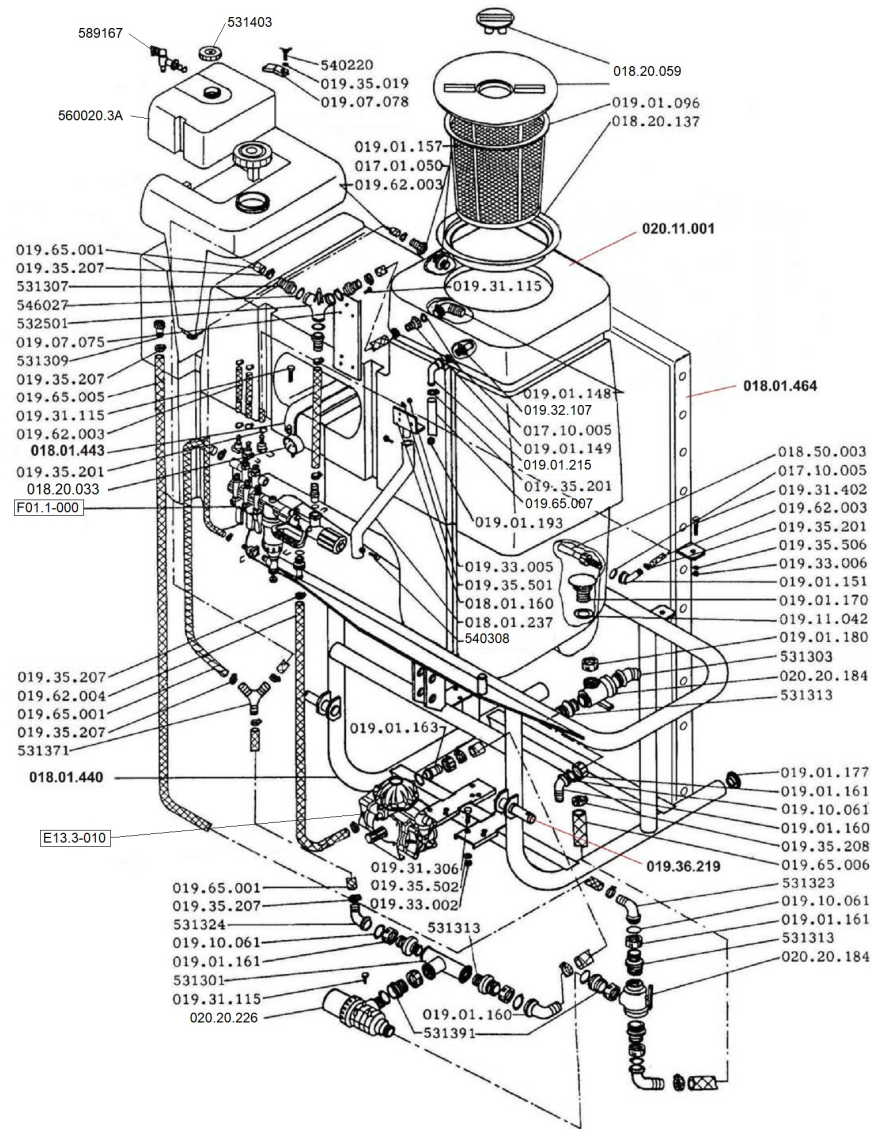

AGS 400 EN_L

| Pos. | Code | Description | Unit | Qty |
|------------|------------|--|------|-----|
| 017.01.050 | 017.01.050 | "NASTAVEK ZA CEV R1/2"-fi14" | | 0 |
| 017.10.005 | 017.10.005 | "TESNILO ""O"" fi24,5x2,7 (DTM 70 Sh)" | | 0 |
| 018.01.160 | 018.01.160 | CONSOLE NOSILCA PR3 | | 0 |
| 018.01.237 | 018.01.237 | BRACKET REGULATORJA AGS-E | | 0 |
| 018.01.440 | 018.01.440 | FRAME AGS 400 EN | | 0 |
| 018.01.443 | 018.01.443 | TAPE VEZNI AGS 400 EN | | 0 |
| 018.01.464 | 018.01.464 | CROSSBAR NOSILNA AGS 400 EN-L | | 0 |
| 018.20.033 | 018.20.033 | MANOMETER GLIC.fi63/0-8-15-20 | | 0 |
| 018.20.059 | 018.20.059 | POKROV REZERVOARJA fi455-KPL. | | 0 |
| 018.20.137 | 018.20.137 | GRLO REZERVOARJA fi460 | | 0 |
| 018.50.003 | 018.50.003 | NOZZLE MEŠALNA-EJEKTORSKA | | 0 |
| 019.01.096 | 019.01.096 | CEDILO REZERVOARJA fi400 | | 0 |
| 019.01.148 | 019.01.148 | """"""ANGLE fi 25 R 1"""""" Z"""""" | | 0 |
| 019.01.149 | 019.01.149 | """"""ADAPTER fi 25-R 1"""""" N"""""" | | 0 |
| 019.01.151 | 019.01.151 | "KOLENO fi13-R 1/2"" -N" | | 0 |
| 019.01.157 | 019.01.157 | "DVOVIJAČNIK R 1/2"" | | 0 |
| 019.01.160 | 019.01.160 | "KOLENO fi 40-1 1/2"" | | 0 |
| 019.01.161 | 019.01.161 | "MATICA R 1 1/2"" | | 0 |
| 019.01.163 | 019.01.163 | NASTAVEK fi40-1 1/2" | | 0 |
| 019.01.170 | 019.01.170 | "NASTAVEK PROTIVRTINČNI R 5/4"" | | 0 |

| Pos. | Code | Description | Unit | Qty |
|------------|------------|--|------|-----|
| 019.01.177 | 019.01.177 | "ČEP fi 6_4"" PVC" | | 0 |
| 019.01.180 | 019.01.180 | "MATICA R 1 1/4"" -SKOZNJA" | | 0 |
| 019.01.193 | 019.01.193 | KROGLICA fi 12 | | 0 |
| 019.01.215 | 019.01.215 | "KOLENO fi 13-R 1/2"" -Z" | | 0 |
| 019.07.075 | 019.07.075 | BRACKET TROPOT.VENTILA L=400 | | 0 |
| 019.07.078 | 019.07.078 | PLATE VEZNA-REZERVOARJA | | 0 |
| 019.10.061 | 019.10.061 | "TESNILO ""O"" fi36xfi30x3 ARAG (G 10061)" | | 0 |
| 019.11.042 | 019.11.042 | TESNILO fi60,0xfi40,0x4,0 (NBR) | | 0 |
| 019.31.115 | 019.31.115 | VIJAK M8x16(8.8Zn)DIN912 | | 0 |
| 019.31.306 | 019.31.306 | VIJAK M10x20(8.8Zn)DIN933 | | 1 |
| 019.31.402 | 019.31.402 | Vijak M12x30 (8.8 Zn) DIN 931 | | 0 |
| 019.32.107 | 019.32.107 | "MATICA R 1/2""x7 - Al" | | 0 |
| 019.33.002 | 019.33.002 | MATICA M10(8.8Zn)DIN934 | | 0 |
| 019.33.005 | 019.33.005 | Matica M8 (8.8 Zn) DIN 934 | | 1 |
| 019.33.006 | 019.33.006 | Matica M12 (8.8 Zn) DIN 934 | | 10 |
| 019.35.019 | 019.35.019 | Podložka 8,4 (Zn) DIN 9021 | | 0 |
| 019.35.201 | 019.35.201 | OBJEMKA fi12-fi22 | | 5 |
| 019.35.207 | 019.35.207 | OBJEMKA fi20-fi32 | | 0 |
| 019.35.208 | 019.35.208 | OBJEMKA fi32-fi50 | | 0 |
| 019.35.501 | 019.35.501 | PODLOŽKA 8,0(ZN)DIN127-B | | 6 |

| Pos. | Code | Description | Unit | Qty |
|------------|------------|-----------------------------------|------|-----|
| 019.35.502 | 019.35.502 | PODLOŽKA 10,0(ZN)DIN127-B | | 0 |
| 019.35.506 | 019.35.506 | PODLOŽKA 12,0(ZN)DIN127-B | | 0 |
| 019.36.219 | 019.36.219 | BOLT NOSILNI fi 22 / M 20 x 102 | | 0 |
| 019.62.003 | 019.62.003 | CEV PLAST. fi13x23 | m | 1 |
| 019.62.004 | 019.62.004 | CEV GUMI fi25x5 | m | 0 |
| 019.65.001 | 019.65.001 | CEV PVC ARMIRANA fi25x32 | m | 0 |
| 019.65.005 | 019.65.005 | TUBE PVC ARMIRANA fi60x5-Z ŽICO | m | 0 |
| 019.65.006 | 019.65.006 | CEV PVC ARMIRANA fi40x50 | m | 0 |
| 019.65.007 | 019.65.007 | CEV PVC ARMIRANA fi14x3 | m | 0 |
| 020.11.001 | 020.11.001 | TANK AGS 400/3PZ | | 0 |
| 020.20.184 | 020.20.184 | "VENTIL TROPOTNI R1 1/4"" FF" | | 0 |
| 020.20.226 | 020.20.226 | "FILTER SESALNI 170-R1 1/2""-32" | | 0 |
| 531301 | 531301 | KOS T R1 1/4" FF | | 0 |
| 531303 | 531303 | "KOLENO fi30/R1 1/4""/45°" | | 0 |
| 531307 | 531307 | ADAPTER fi25 | | 0 |
| 531309 | 531309 | "NASTAVEK fi30-R1 1/4"" M" | | 0 |
| 531313 | 531313 | "REDUCIR R1 1/2""" | | 0 |
| 531323 | 531323 | "KOLENO fi 30 ZA MATICO G1 1/2""" | | 0 |
| 531324 | 531324 | KOLENO fi 25 ZA MATICO G 1 1/2" | | 0 |
| 531371 | 531371 | PART Y fi25-fi25-fi25 | | 0 |

AGS 400 EN_L

| Pos. | Code | Description | Unit | Qty |
|-----------|-----------|---|------|-----|
| 531391 | 531391 | "SPOJKA REDUCIRNA R1 1/2"" - R1 1/4"" | | 0 |
| 531403 | 531403 | POKROV fi 80-KPL | | 0 |
| 532501 | 532501 | VALVE TROPOTNI | | 0 |
| 540220 | 540220 | SCREW M8x20 DIN 316 | | 0 |
| 540308 | 540308 | ZATIČNI VIJAK M10x15 (8.8 (Zn)) DIN 914 | | 0 |
| 546027 | 546027 | SEAL "O" fi 25x 2 NBR | | 0 |
| 560020.3A | 560020.3A | TANK ZA ČISTO VODO | | 0 |
| 589167 | 589167 | PIPE R3/4" PVC BELA | | 0 |